

Wire Plugging Schematic

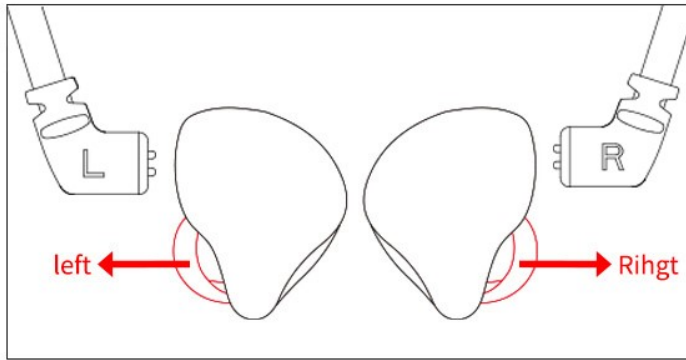

Correctly Distinguish Right And Left Headphones And Wires: (as shown)
There are left and right logos on the wire, "L" is on the left, and "R" is on the right.
The front of the headset is placed with the silicone sleeve facing left to the left and the silicone sleeve facing to the right, which is the right side.

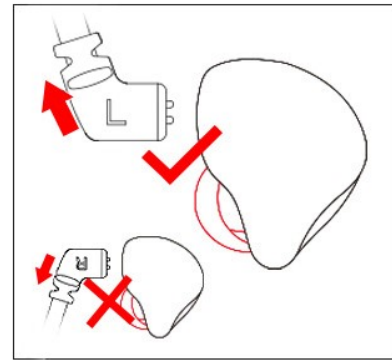

The correct assembly of the wire is with the needle head and "L R" logo facing up. Do not assemble the pin head down and it will have an adverse effect on sound quality.

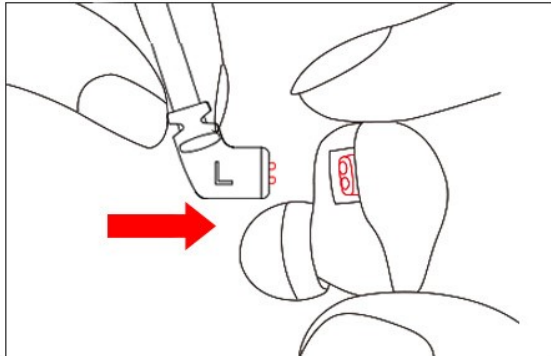

Point the wire to the plug and push it in until it fits perfectly

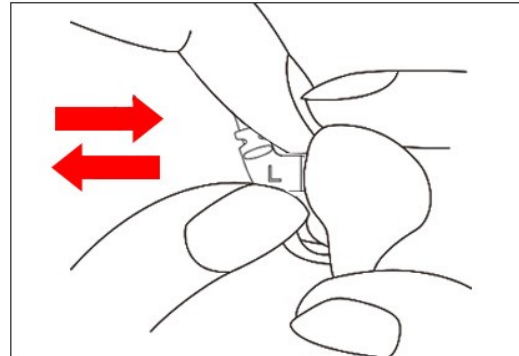

Since the wire is a design that does not easily come off, Please be careful when inserting or pulling.

Schematic Diagram Of Headset Wearing

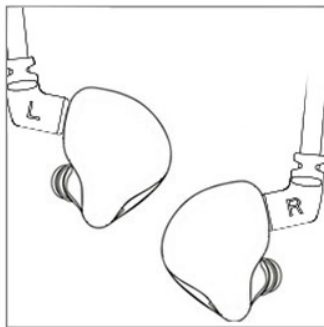

Correctly distinguish right and left headphones, "L" for left, "R" for right.



Straight headphones inserted into the ear, correct wear, comfortable wear, good sound insulation performance.

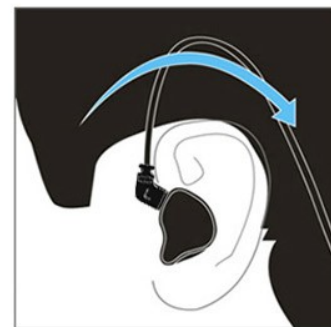

Fix the headset wire behind the ear.

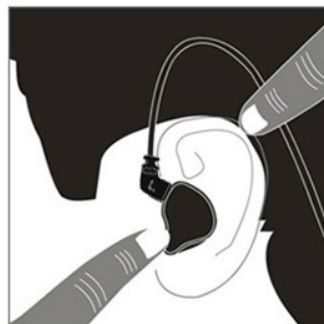

Press and hold the headset panel to adjust the seal.



Adjust earphone wire and fix earphone.



Plug the headset plugs into the play-back device and use the device to adjust the volume before the headset is plugged into the device.