

# 166xs Compressor

Compressor/Limiter/Gate

**dbx**  
by HARMAN



## Bring a more professional sound to your mix

Adding a dbx® 166xs Compressor/Limiter/Gate to your live sound rig or studio gives you more dynamic control to help create a more polished, professional sound. Having compression in your audio chain gives you the ability to smooth out uneven levels, add sustain to guitars and fatten up your drums. It also makes it easy to bring vocals to the front of your mix – adding greater clarity and making them stand out from the surrounding instruments. To protect your expensive amps and speakers the PeakStop® limiter provides an absolute ceiling for peak excursions or large transients that could damage your equipment.

dbx knows compressors...after all we invented them! The 166xs is the latest in a long line of the world's most successful compressors from the inventors of the technology. Its patented Overeasy® compression technology provides smooth and musical performance while the AutoDynamic™ attack and release controls, found only on dbx compressors, puts great sound within easy reach. The 166xs can operate in stereo or dual-mono modes, has true RMS power summing and features quality XLR and 1/4" TRS inputs and outputs. It cuts no corners on visual feedback with gain reduction metering and easy-to-read backlit switches.

## Features

- ▶ Error-proof operation to smooth uneven levels, add sustain to guitars, fatten drums or tighten up mixes
- ▶ New gate timing algorithms ensure the smoothest release characteristics
- ▶ Program-adaptive expander/gates
- ▶ Great sounding dynamics control for any type of program material
- ▶ Separate precision LED displays for gain reduction, compression threshold and gate threshold allow quick, accurate setup
- ▶ Stereo or dual-mono operation
- ▶ Balanced inputs and outputs on 1/4" TRS and XLR connectors
- ▶ Side Chain insert
- ▶ Classic dbx "Auto" mode

## Who uses this product:



BANDS



DJs



SOUND  
INSTALLATION



STUDIO



BROADCAST

dbx Professional  
Products

8760 S. Sandy Pkwy.  
Sandy, Utah 84070

1.801.568.7660 PHONE  
1.801.568.7662 FAX

1.801.568.7583 INT'L FAX  
customer@dbxpro.com  
www.dbxpro.com

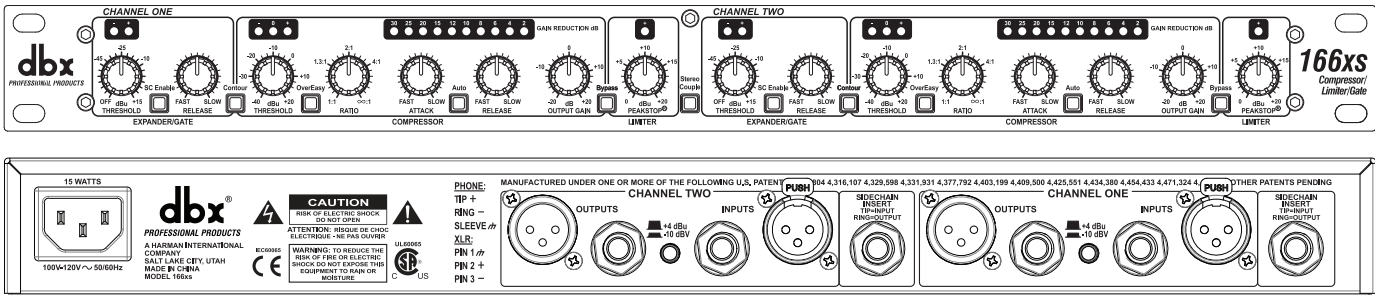

## Specifications

**INPUTS:** 1/4" TRS, female XLR (pin 2 hot)  
**Type:** Electronically balanced/unbalanced, RF filtered  
**Impedance:** >50kΩ Balanced, >25kΩ unbalanced  
**Max Input Level:** >+24dBu balanced or unbalanced

**OUTPUTS:**  
**Connectors:** 1/4" TRS, male XLR (pin 2 hot)  
**Type:** Electronically-balanced/unbalanced, RF filtered  
**Impedance:** 120Ω balanced, >60Ω unbalanced  
**Max Output Level:** >+21dBu balanced/unbalanced into 2kΩ or greater  
 >+20dBm balanced/unbalanced (into 600Ω)

**SIDECHAIN INSERT:** Normalled: Tip is Input, Ring is Output  
**Tip: Impedance** >10kΩ  
**Maximum Level** >+24dBu  
**Ring: Impedance** 2kΩ  
**Maximum Level** >+24dBu

**COMPRESSOR:** Selectable OverEasy® or hard-knee  
**Threshold Range** -40dBu to +20dBu  
**Compression Ratio** Variable; 1:1 to Infinity:1; 60dB Maximum Compression  
**Attack Time** Variable program-dependent; 3ms to 340ms for 15dB gain reduction  
**Release Time** Variable program-dependent; 200dB/Sec to 3dB/Sec

**EXPANDER/GATE:**  
**Threshold Range** OFF to +15dBu  
**Expansion Ratio** 10:1  
**Maximum Depth** >60dB  
**Attack Time** <50μSec (from Maximum Depth)  
**Release Time** Adjustable, 30ms to 3sec (to 30dB attenuation)

**PEAKSTOP® LIMITER:**  
**Threshold Range** 0dBu to +20dBu

**SYSTEM PERFORMANCE:**  
**Frequency Response:** 20Hz - 20kHz, +0/-0.5dB, Typical 3dB points are 0.35Hz and 110kHz, unity gain  
**Noise:** <-90dBu, 22Hz to 22kHz, no weighting, unity gain  
**THD+N:** Typically <0.04%; Any Amount of Compression Up to 40dB@1kHz  
**SMPT E IMD:** Typically <0.08% @ +10dBu (15dB Gain reduction)  
**Dynamic Range:** >115dB, unweighted  
**Interchannel Crosstalk:** <-80dB, 20Hz to 20kHz  
**Common Mode Rejection:** >40dB, typically >55dB @ 1kHz  
**Stereo Coupling:** True RMS Power Summing™

**POWER SUPPLY:**  
**Power Requirements** 15 Watts  
**Operating Voltage** 100 VAC 50/60Hz; 120VAC 60Hz; 230 VAC 50/60 Hz  
**Operating Temperature** 32°F to 113°F (0°C to 45°C)

**PHYSICAL:**  
**Dimensions** 1.75" x 6.75" x 19" (4.5cm x 17.15cm x 48.26cm)  
**Weight** Net Weight: 5.05 lbs/2.29 Kg  
**Shipping Weight:** 7.20 lbs/3.27 Kg

Note: 0dBu = 0.775VRMS

dbx engineers are constantly working to improve the quality of our products. Specifications are, therefore subject to change without notice.